

Electric 6 level and 10 level 1/1 Combi oven with Boiler

CPRO-0610/1-22

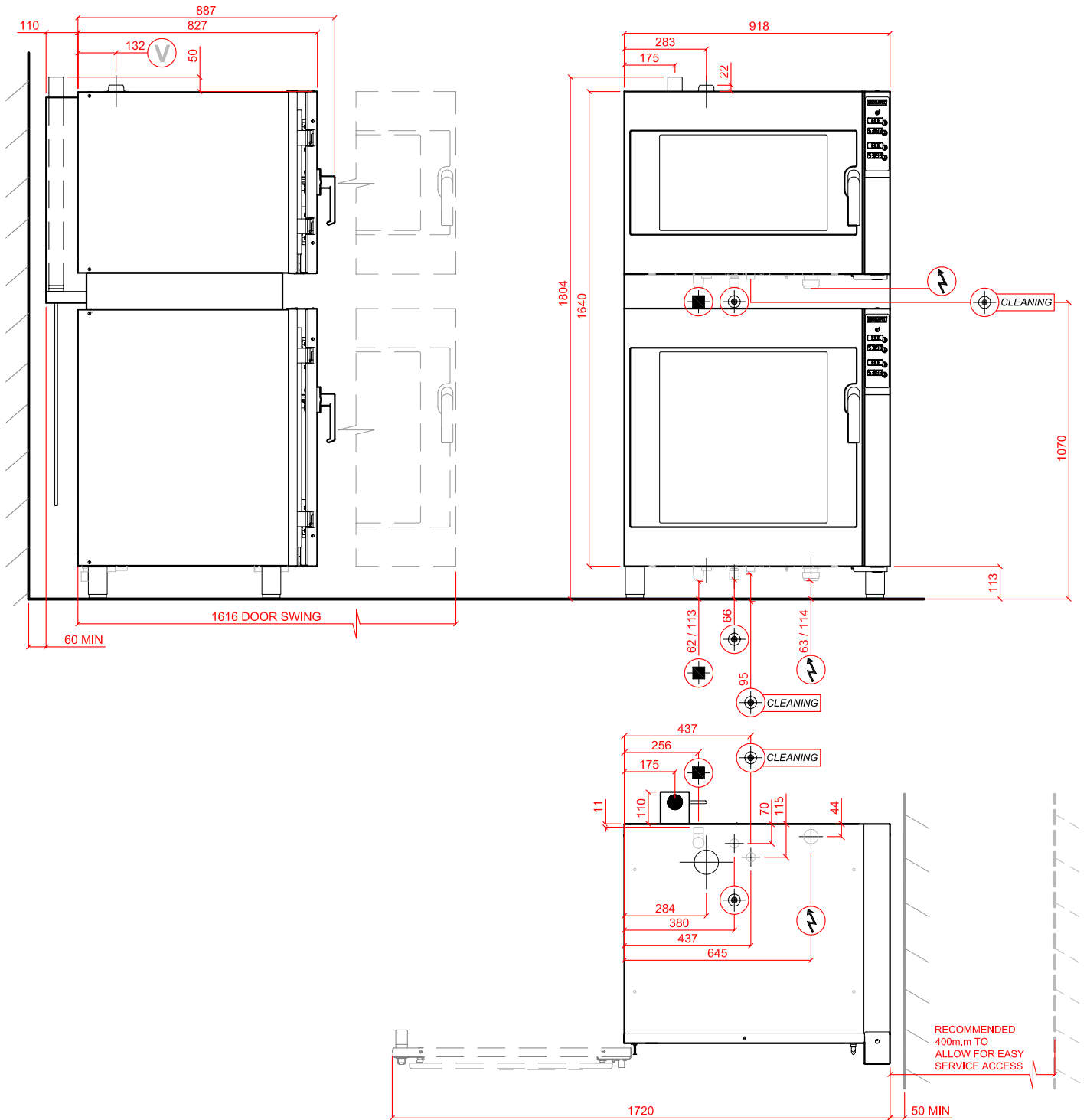

Water	Drain	Electric Loading	Vent Outlet
2 x 3/4" B.S.P. POTABLE WATER. 7.5 LITRE/MIN. 2.0 TO 5.0 BAR PRESSURE MAX TEMP: 25°C	2 x 1" B.S.P. DRAIN	<b>6 GRID:</b> 9.4kW 400/50/3 + N + E FUSE AT 16 AMPS/PHASE <b>10 GRID:</b> 18.4kW 400/50/3 + N + E FUSE AT 32 AMPS/PHASE	2 x 44mm Ø RECOMMENDED EXTRACTION FLOW 390m <sup>3</sup> /hour EACH
2 x 3/4" B.S.P. FOR CLEANING	<b>SPECIAL NOTE: DO NOT INSTALL UNIT CLOSE TO HOT APPLIANCES ON CONTROL PANEL SIDE UNIT SHOULD BE LOCATED UNDER A VENTILATION CANOPY. WEIGHT 243kg</b>		
RIGHT TO MAKE NECESSARY CHANGES IS RESERVED			

